

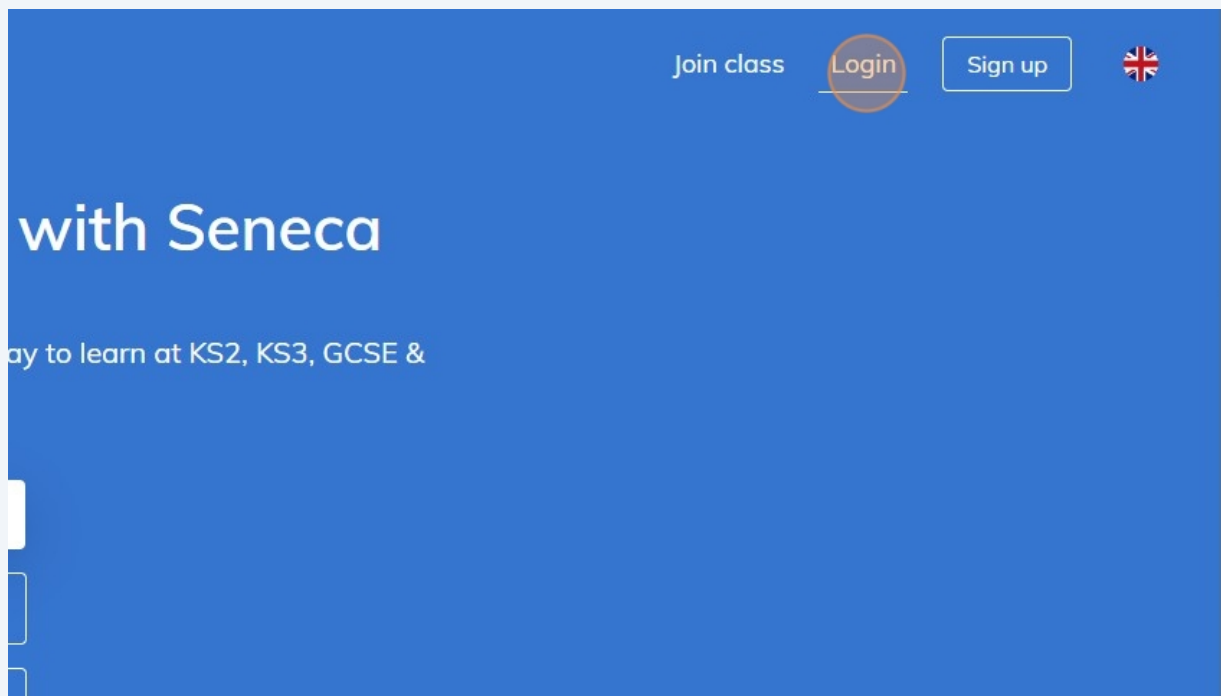

Navigate to _____



Click "Login".





Click "Continue with Microsoft".

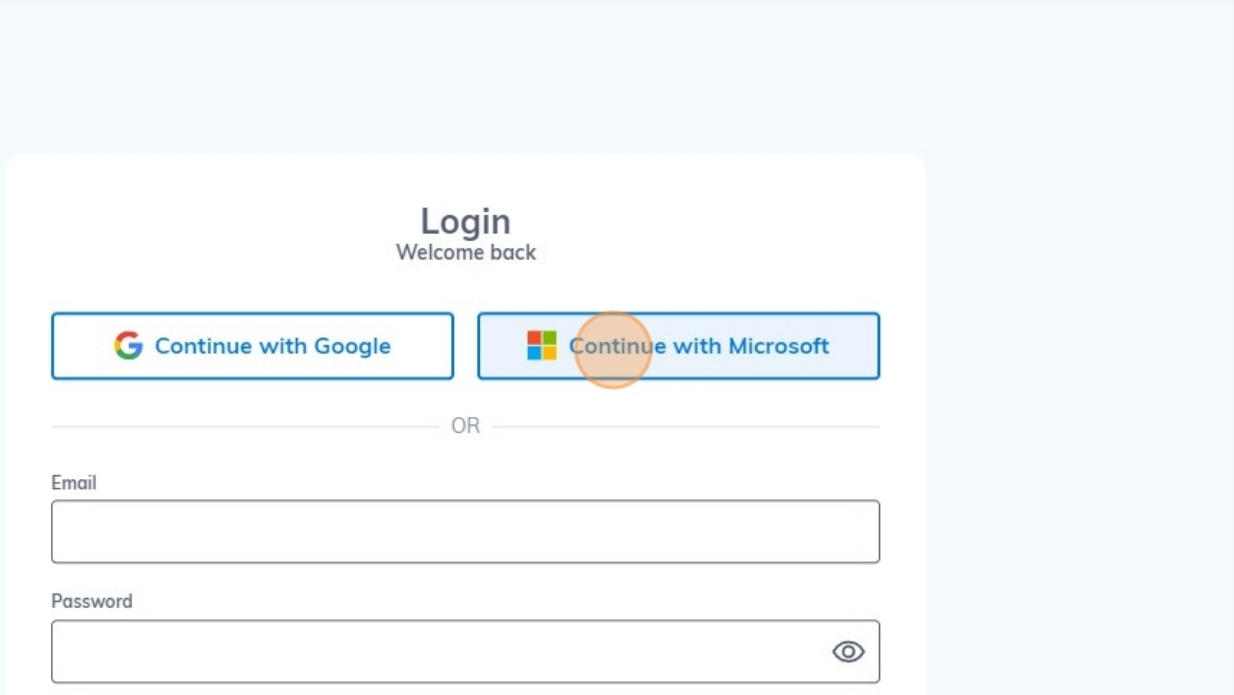

Enter your school email address

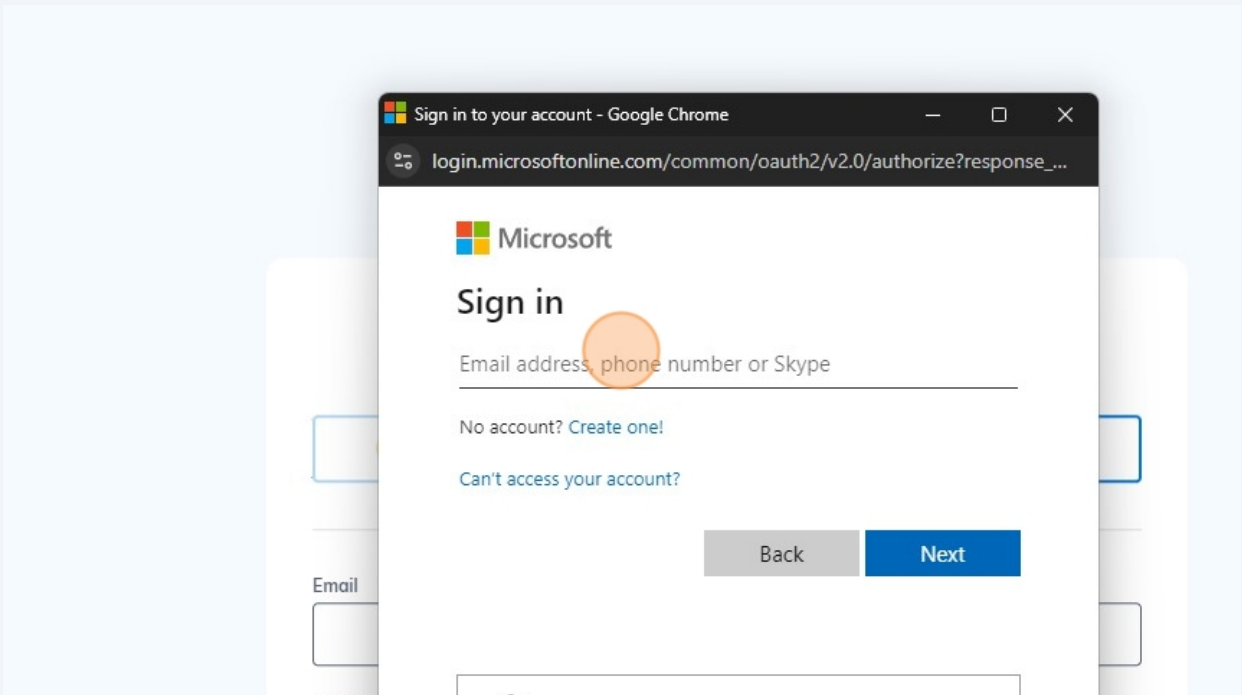



Click "Next".

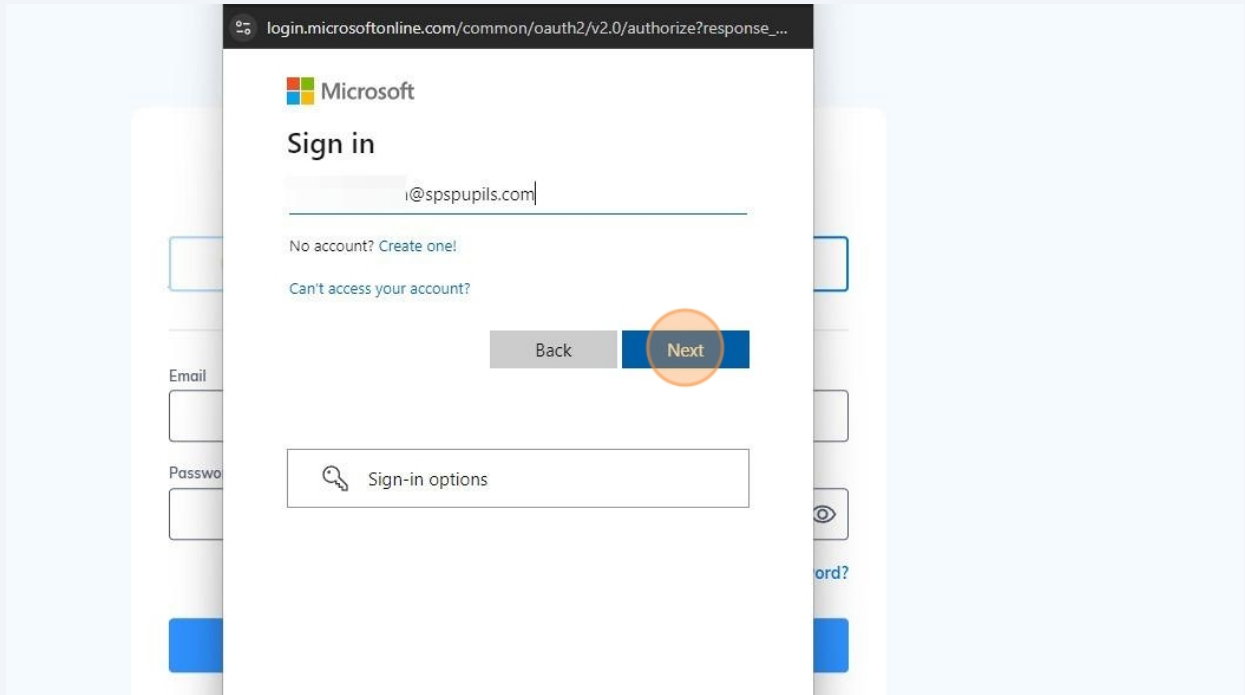

Enter your school computer password.

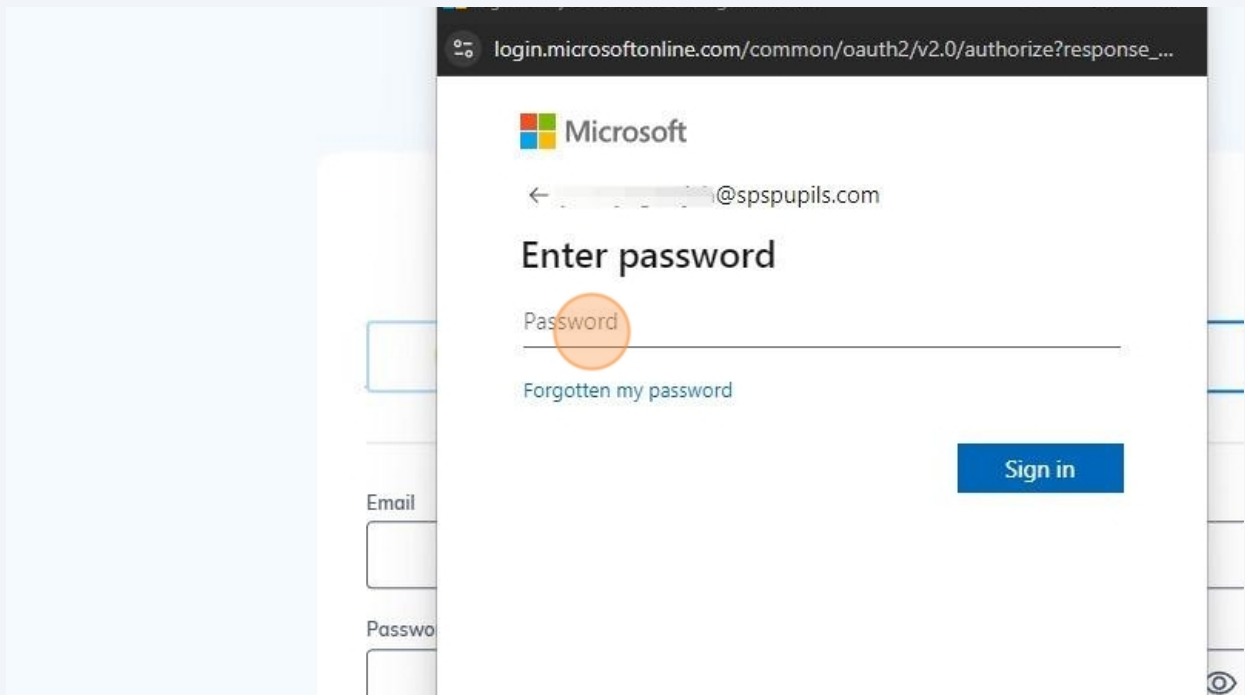



Click "Sign in"

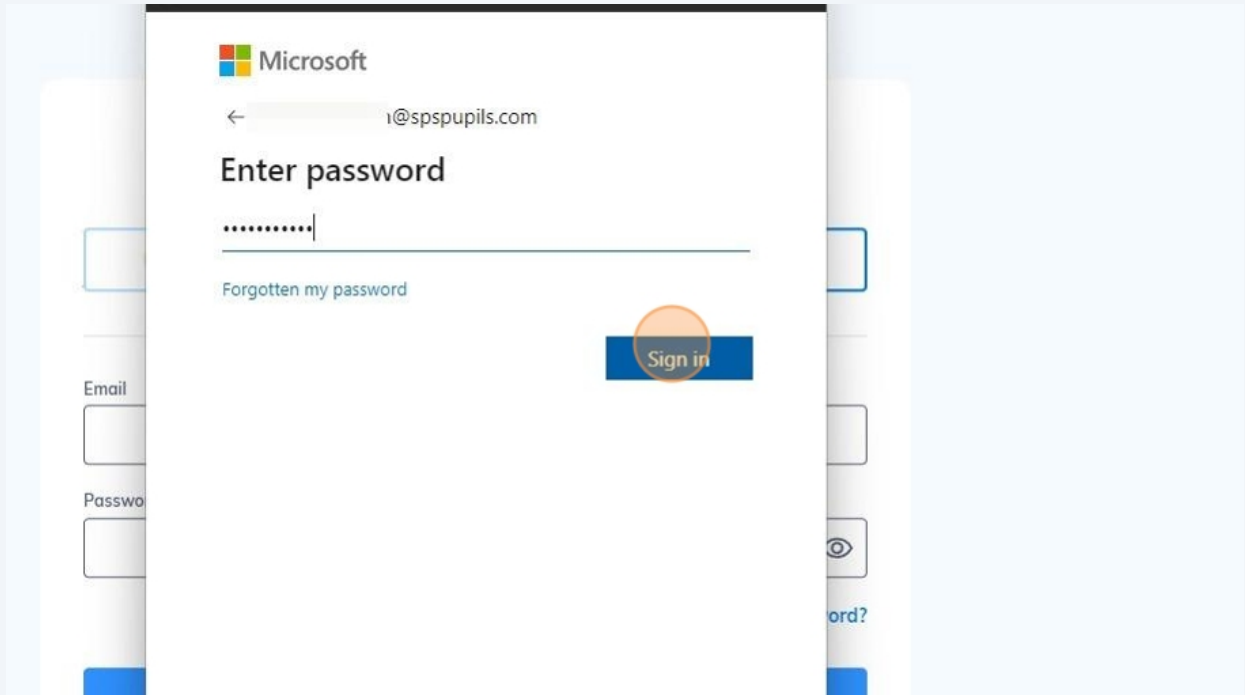

If prompted for more information click "Next"

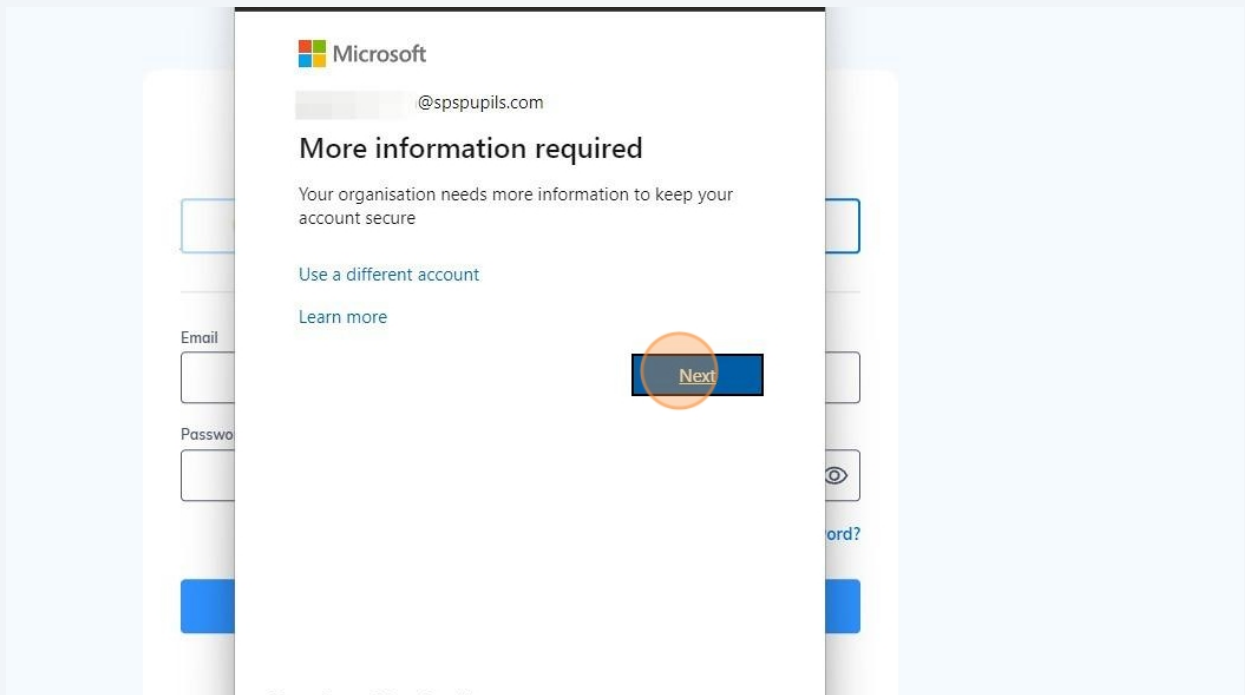



It is recommended to setup 2 factor authentication by clicking next and following the instructions this adds an extra layer of security to your Microsoft Account. Alternatively you can click [Skip setup](#).

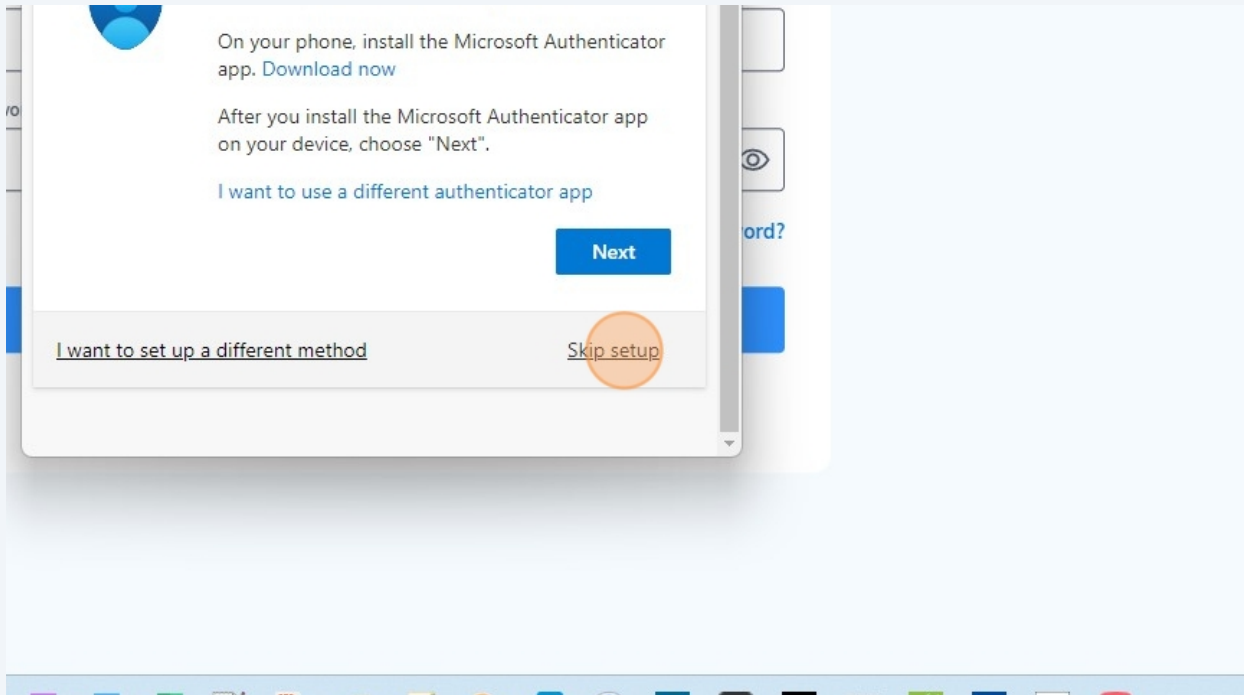

Click "Yes"

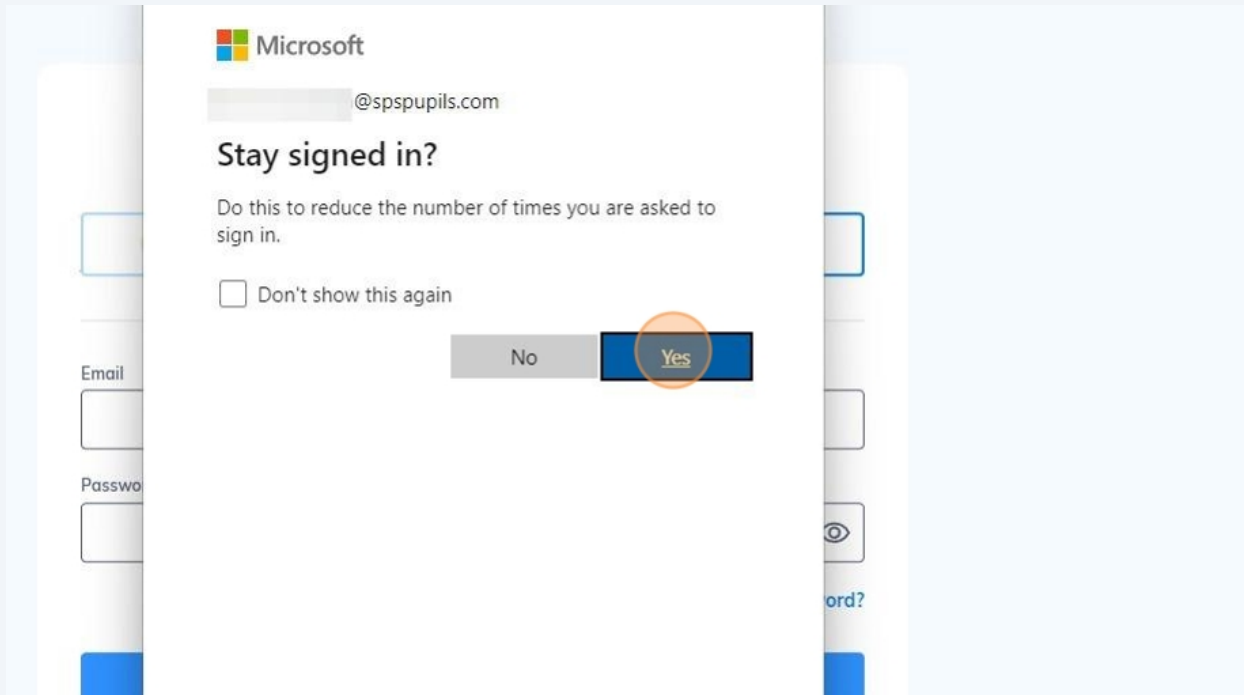



This will then log you in to your Seneca account